

reducing elbow - ISO 4144

[short name: RW.I\\*](#)

90° - F/F

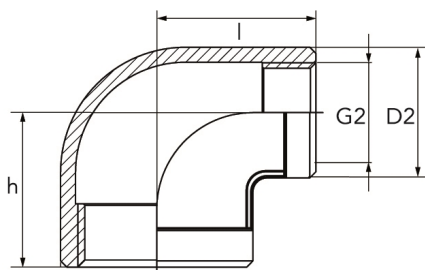

## technical product sheet

| G      | G2     | D    | D2   | h    | l    | Art.-Nr.   |
|--------|--------|------|------|------|------|------------|
| 1/4"   | 1/8"   | 19,0 | 15,5 | 18,5 | 18,5 | RW-014-018 |
| 3/8"   | 1/8"   | 22,5 | 15,5 | 20,5 | 22,5 | RW-038-018 |
| 3/8"   | 1/4"   | 22,5 | 22,5 | 19,5 | 20,5 | RW-038-014 |
| 1/2"   | 1/8"   | 27,5 | 15,5 | 24,5 | 24,5 | RW-012-018 |
| 1/2"   | 1/4"   | 27,5 | 19,0 | 22,5 | 23,5 | RW-012-014 |
| 1/2"   | 3/8"   | 27,5 | 22,5 | 26,5 | 25,5 | RW-012-038 |
| 3/4"   | 1/4"   | 33,0 | 19,0 | 28,5 | 28,5 | RW-034-014 |
| 3/4"   | 3/8"   | 33,0 | 22,5 | 29,5 | 30,5 | RW-034-038 |
| 3/4"   | 1/2"   | 33,0 | 27,5 | 31,0 | 31,0 | RW-034-012 |
| 1"     | 1/4"   | 40,5 | 19,0 | 30,5 | 32,0 | RW-100-014 |
| 1"     | 3/8"   | 40,5 | 22,5 | 34,5 | 35,5 | RW-100-038 |
| 1"     | 1/2"   | 40,5 | 27,5 | 28,5 | 30,5 | RW-100-012 |
| 1"     | 3/4"   | 40,5 | 33,0 | 35,0 | 36,0 | RW-100-034 |
| 1 1/4" | 3/8"   | 50,0 | 22,5 | 38,5 | 40,5 | RW-114-038 |
| 1 1/4" | 1/2"   | 50,0 | 27,5 | 34,0 | 36,5 | RW-114-012 |
| 1 1/4" | 3/4"   | 50,0 | 33,0 | 36,5 | 38,5 | RW-114-034 |
| 1 1/4" | 1"     | 50,0 | 40,5 | 40,5 | 42,5 | RW-114-100 |
| 1 1/2" | 3/8"   | 56,5 | 22,5 | 38,5 | 43,5 | RW-112-038 |
| 1 1/2" | 1/2"   | 56,5 | 27,5 | 34,0 | 40,0 | RW-112-012 |
| 1 1/2" | 3/4"   | 56,5 | 33,0 | 38,5 | 51,0 | RW-112-034 |
| 1 1/2" | 1"     | 56,5 | 40,5 | 41,5 | 45,5 | RW-112-100 |
| 1 1/2" | 1 1/4" | 56,5 | 50,0 | 45,5 | 48,5 | RW-112-114 |
| 2"     | 1/2"   | 70,0 | 27,5 | 42,0 | 51,5 | RW-200-012 |
| 2"     | 3/4"   | 70,0 | 33,0 | 44,0 | 52,5 | RW-200-034 |
| 2"     | 1"     | 70,0 | 40,5 | 46,5 | 53,5 | RW-200-100 |
| 2"     | 1 1/4" | 70,0 | 50,0 | 52,5 | 55,5 | RW-200-114 |
| 2"     | 1 1/2" | 70,0 | 56,5 | 48,5 | 54,5 | RW-200-112 |

available material: V4A

Threaded fittings > fittings > PN 16/ 20 (ISO 4144) > elbows / bends > red. elbows 90°



## Reducing Elbow

90° - socket connection

### Version

standard according to ISO 4144

material AISI 316 / 1.4407 (V4A)

inspection certificate (APZ) according to DIN EN 10204-3.1

female thread cylindrical according to ISO 228-1 (Code G)

### Design

#### Temperature\*

-20 to 40 °C

100 °C

150 °C

200 °C

220 °C

#### Pressure\*\*

20 bar

16 bar

15 bar

14 bar

13 bar

\* of the medium

\*\* max. vibration-free operating pressure